

BRITISH EMBASSY,  
BERLIN

Public and Government

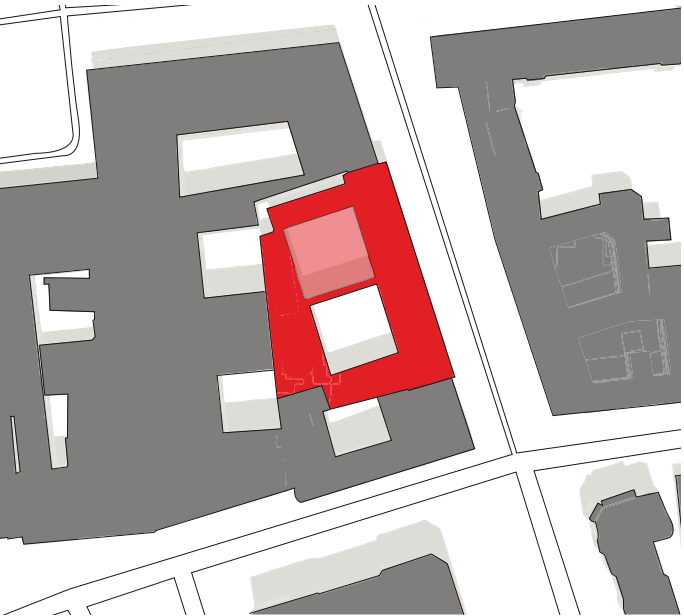

British Embassy, Berlin, New Building  
Competition 1<sup>st</sup> Prize Construction period 1997-2000  
Location Wilhelmstr. 70-71, 10117 Berlin GFA ca. 11.182 m<sup>2</sup> Scope 1-8  
Client Arteos Grundstücksgesellschaft mbH & Co.KG Costs 25,1 Mio €

Ground Plan, ground floor

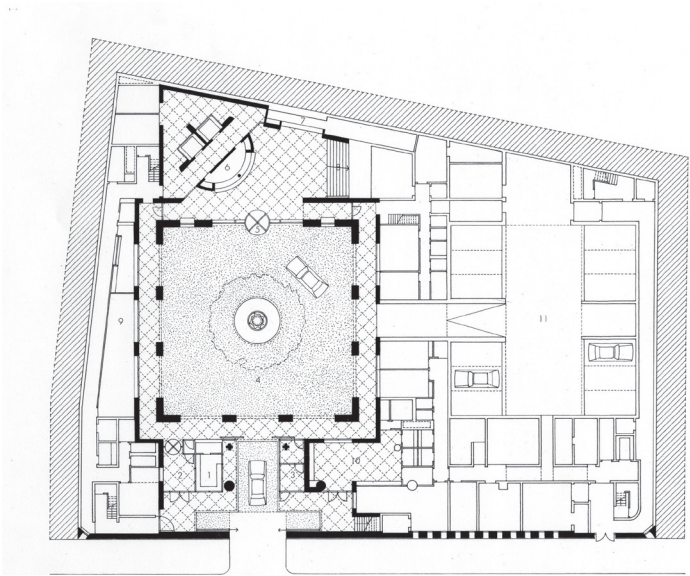

British Embassy

The architecture of the New British Embassy is a combination of modern and traditional elements as well as being a blend of British and German elements, which are represented through the facade design and the interior colour system. The composition is a balance of stone, plane and void, terminated at the top by a cornice and mansard screen that relates the building to the height of the surroundings and provides a reference to the built environment. The formal strength of the figure is interrupted by an abstract collage of forms, revealed through the large opening in the facade. The streets close to the Brandenburger Gate and the Pariser Platz were formerly lined with majestic buildings and gardens. The site at Wilhelmstrasse, in the old and new governmental quarter of Berlin, has been the location for the diplomatic representation of Great Britain in Germany since 1884. The original embassy building was destroyed in the Second World War and the site was left empty since then. The brief for the New British Embassy was to provide a building which would cater for requirements such as representation, functionality, security and discretion, while simultaneously creating a contemporary expression of Britain.