

B.BRAUN
HEADQUARTERS,
MELSUNGEN

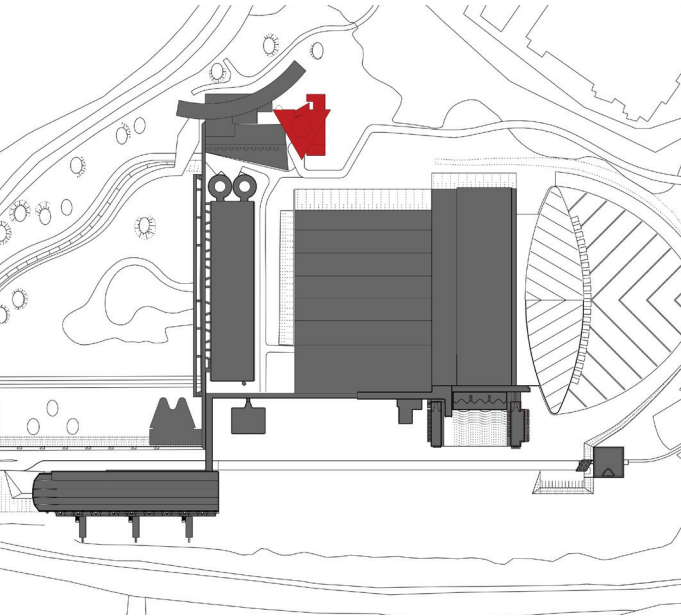

Office and Administration Buildings



B.Braun Headquarters, Melsungen, New Building
Direct commission **Planning period** 1996-1999 **Construction period** 1997-2001 **Location** Pfieffewiesen, 34212 Melsungen **GFA** ca. 5.303 m²
Scope 2-7, Parts of 8 **Client** B.Braun Melsungen AG **Costs** 10,7 Mio €
Award RIBA Award, European Category, 2002

Ground Plan of an upper floor

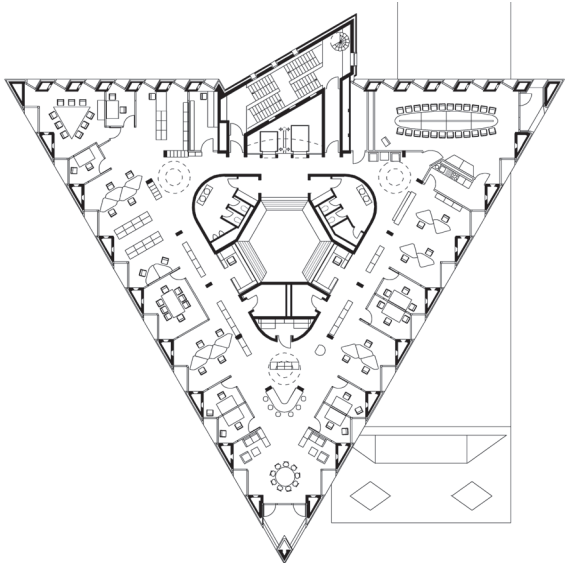

B.Braun Headquarters - A2

The European Headquarters is a stack of three different geometrical volumes. A rectangle with tapered prepatinated copper facades and deep window openings denotes the base. The two story triangular foyer functions as a point of entrance for the three main levels above. An innovative Office Concept was developed and tested during the planning phase of the building. There are no open plan offices, as were common places in the fifties and sixties, but ensembles of spaces, consisting of public, semi-public and semi-private room zones. B. Braun Melsungen AG is a company operating worldwide. Because they compete globally, they must be continuous innovative. Therefore, the project to design new headquarters was based on innovative strategies: This is where the future world of work was to be created.