

MUSEUM OF MODERN
LITERATURE, MARBACH

Competitions

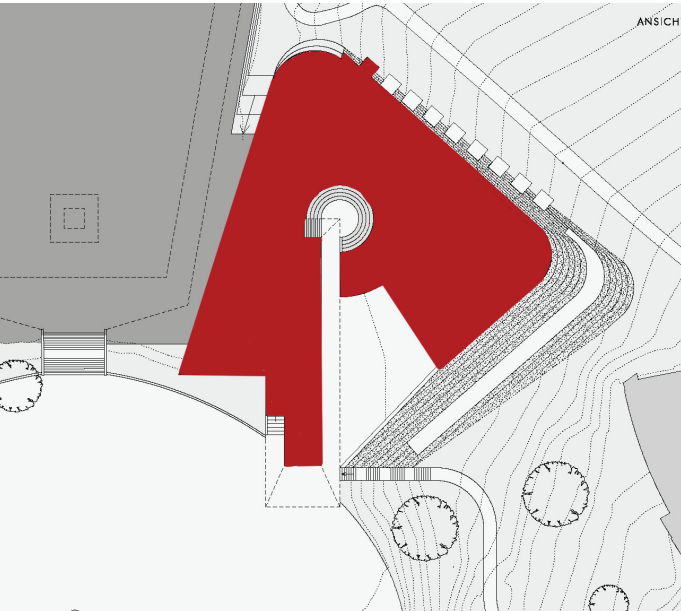
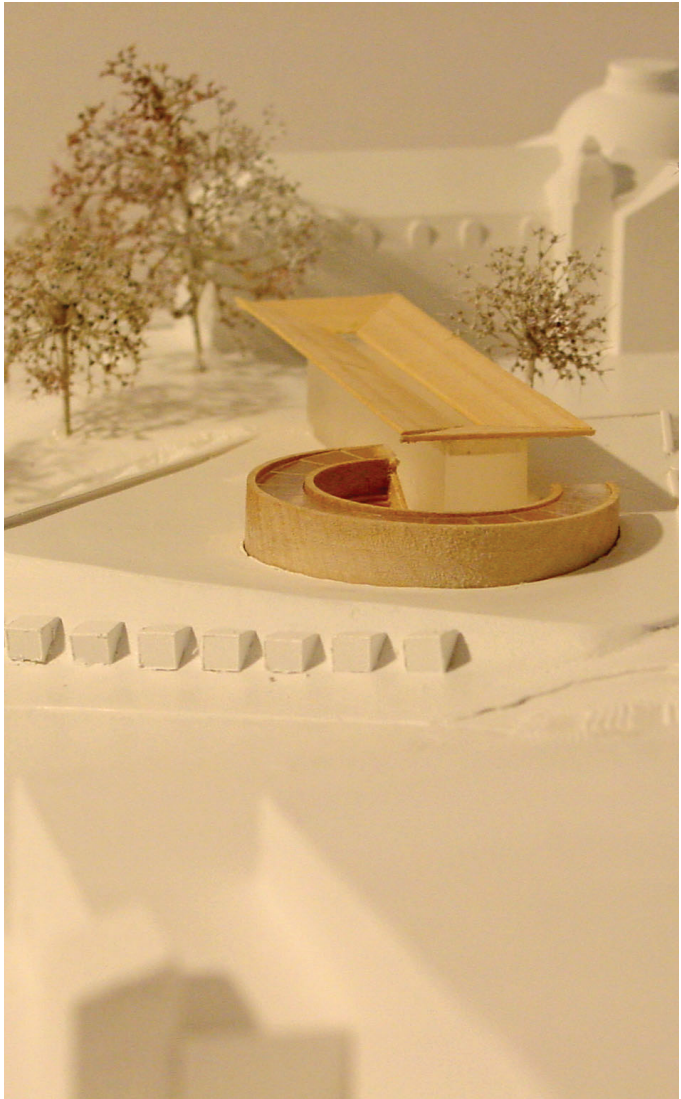
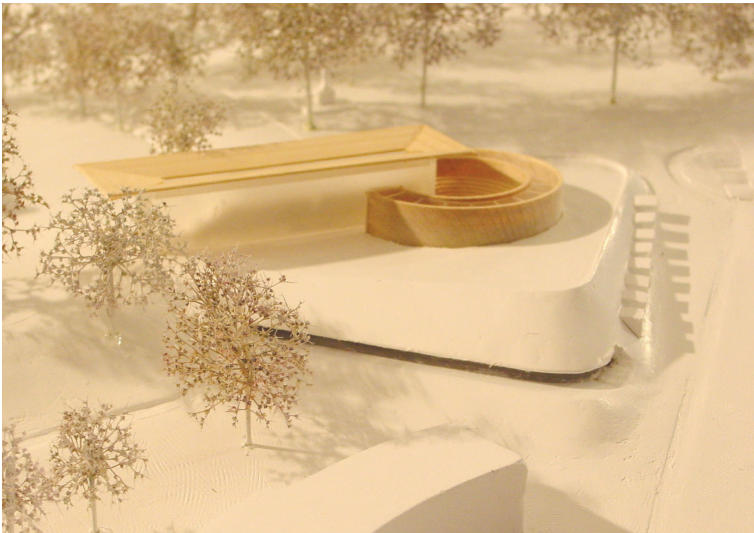
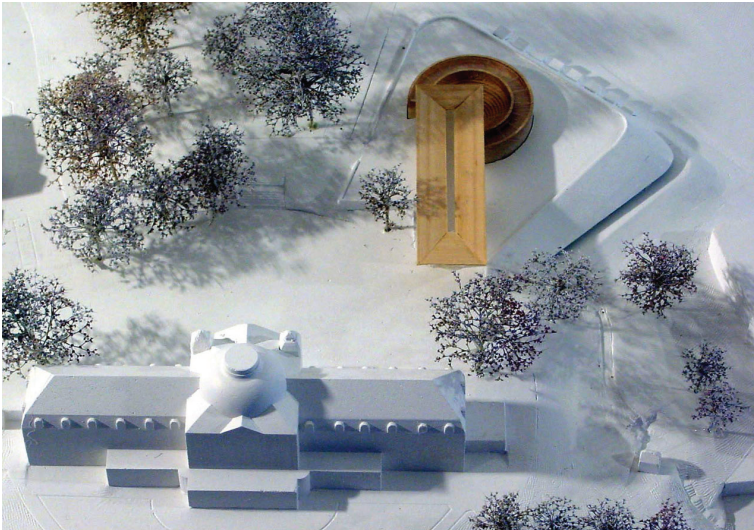
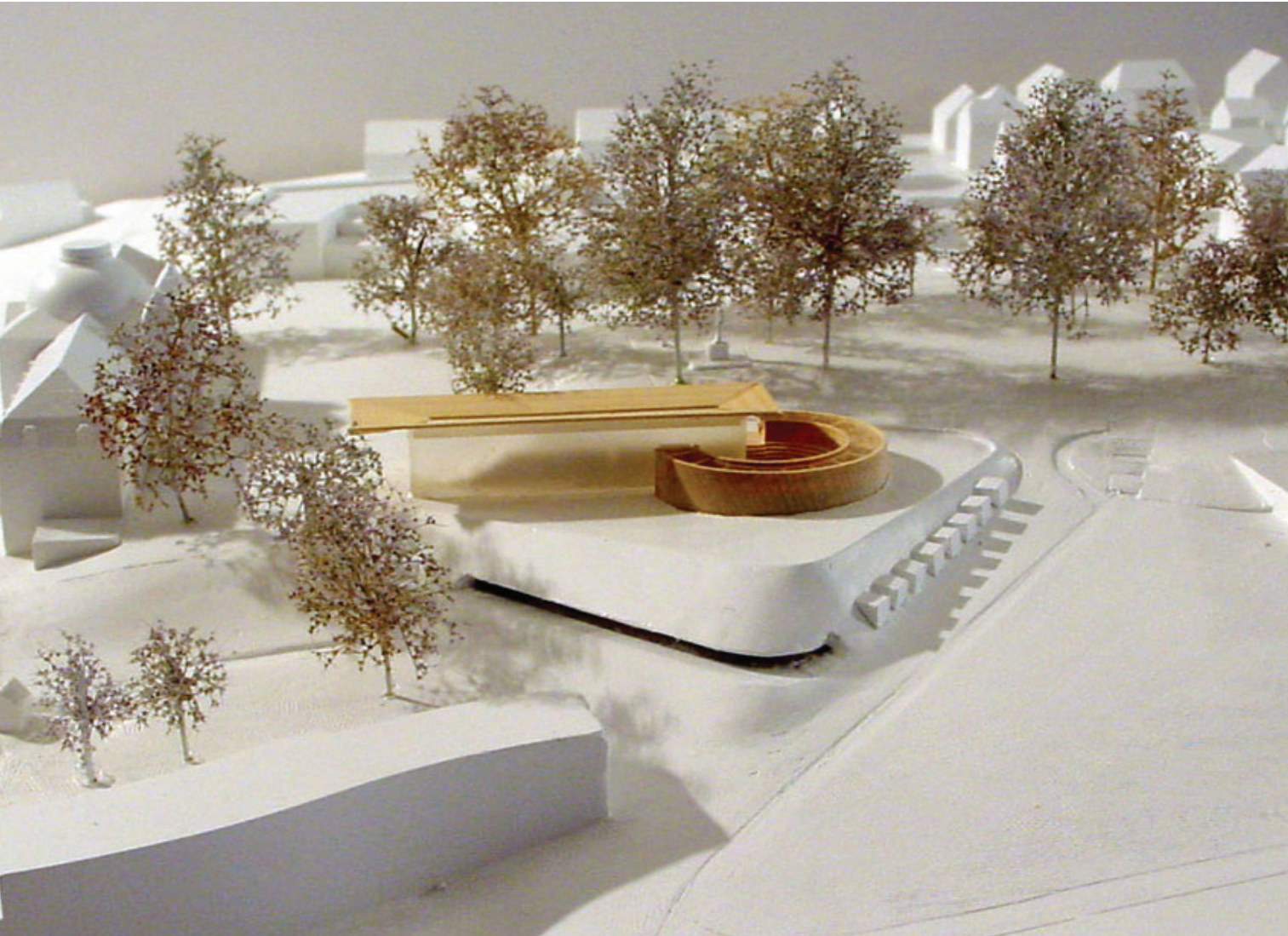

Museum of Modern Literature, Marbach, New Building
Competition 2nd Prize 2001 Location Schillerhöhe, 71672 Marbach

Sections

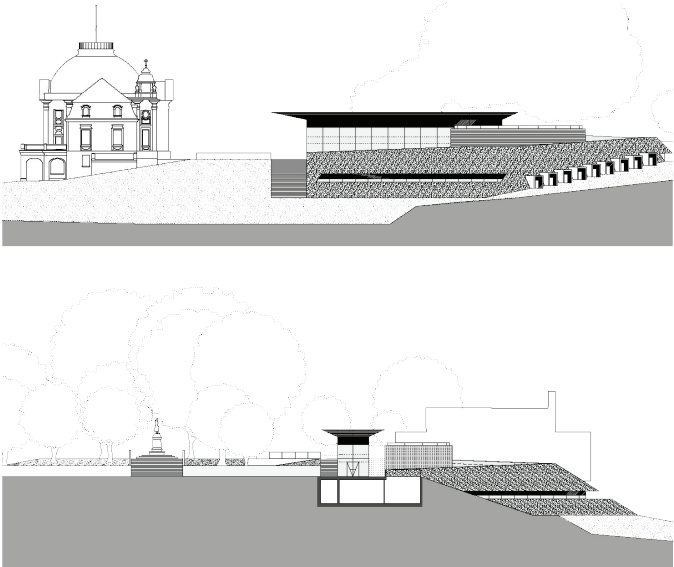

Museum of Modern Literature

The Museum of Modern Literature is situated amongst an ensemble of buildings of three different architectural periods. It is located on the Schiller Hills in Marbach overlooking the river Neckar. The design of the museum, incorporating rotunda, exhibition area and pavilion, is orientated by the three existing axes of the Archive of German Literature, the Schiller National Museum and the Collegiate Building. The lowered rotunda, the centre of the exhibition, relates directly to the axis of the Schiller Monument and the National Museum. The roof of the exhibition area grows from and becomes a part of the landscape inviting the visitors into the arena, to sit down and read under the open sky. The exhibition areas, which are grouped around the rotunda, are sunk into the landscape. The main volume of the museum therefore disappears into the southern face of the Schiller Hills. Entering the building, an exhibition ramp leads into the depth of the building, then curls around the rotunda forming a link to the exhibition spaces. Via an „internal facade“, the visitor enters either singular cabinet exhibition spaces or the large exhibition areas.