

B.BRAUN F.I.V.E. FACTORY,
HANOI

Industrial

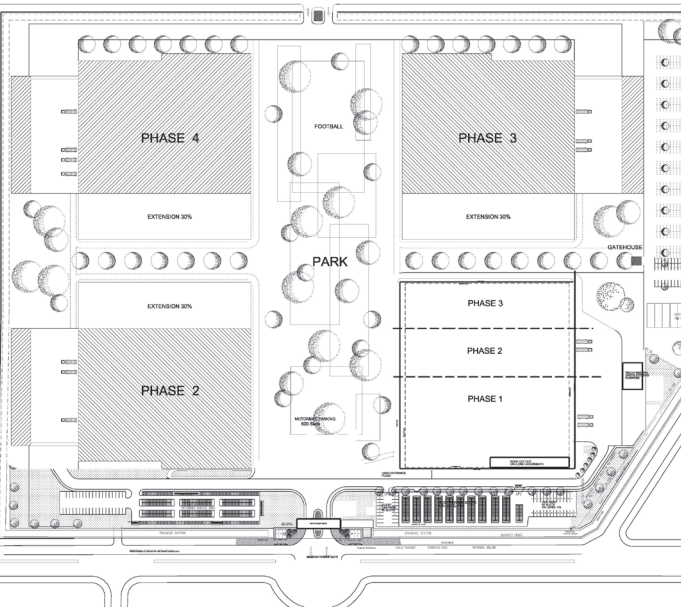

B.Braun F.I.V.E. Factory, Hanoi, New Building
Construction period 2008-2011 **Location** Thanh Oai Industrial Complex,
Thanh Oai dist, Hanoi **Client** B.Braun Melsungen AG

Ground Plan, ground floor

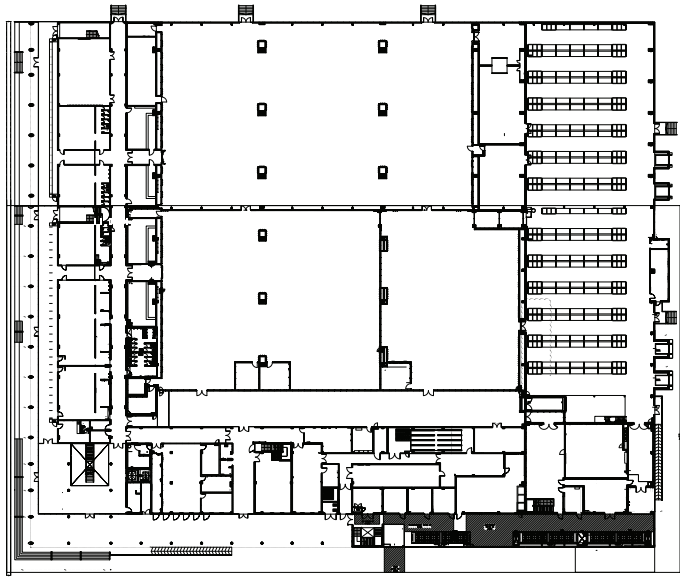

B.Braun F.I.V.E Factory

The B.Braun industrial complex in Hanoi, Vietnam has many similarities with the 'City of Industry' in Melsungen, Germany. The Hanoi Masterplan allows for significant expansion, in this instance, for three more buildings of comparable size to fit onto the site. Further to the flexibility of the masterplan, the Hanoi campus boasts a park, lake, gatehouse, technical buildings and onsite parking. The central park near the lake provides recreational and sports facilities for B.Braun employees. Covered communal areas for informal meetings feature alongside Tennis courts and Football pitches. Changing Facilities are located in a separate pavilion building which also houses Doctors offices and dental services. The factory produces Infusion-Sets and is the largest of its kind in Vietnam. The strategy of 'four identical buildings' was developed to echo local building forms that use large roof overhangs to provide relief from climatic conditions found in tropical regions. These overhangs present an opportunity for external spaces to be used as meeting areas, places for visitors to wait or for employees to spend their break times.